

DIFFUSER OPENING				
3	3/6	3/6/9	3/6/9/12	
60	12	8		
80	16	12	9	
100		15	11	
120		18	13	11
140			16	13
160			18	14
180				16
200				16

FLOW L/MIN

SPINNING SPEED RPM

TECHNICAL DATA

O.RING	NBR – EPDM – VITON
SLIPPER	PTFE+CARBON FIBRE
BUSHING	AISI 316
FILTER	700 MICRON
NOZZLES POSITIONS	2 – 4
NOZZLES THREAD	1/4"NPT
TESTING NOZZLES	0 x 0000
OPERATING FLOW RANGE	60 – 200 L/min
TESTING FLOW	000 L/min
OPERATING PRESSURE RANGE	5 – 200 bar
TESTING PRESSURE	000 bar
CENTER LINE MIN PASS THROUGH HOLE	174 mm
MANUAL MIN PASS THROUGH HOLE	144 mm
MAX OPERATING TEMPERATURE	90 °C
MATERIAL	INOX AISI 316
CONICAL GEARS	FIXED Z=59 ROTATING Z=61
MODULE	1
DIFFUSER SPEED SETTING OPENINGS	4
ROTATION SPEED	SEE CHART
FULL CYCLE	61 ROTATIONS
FULL CYCLE TIME	3.8 min AT 16 RPM
WEIGHT	9.6 KG

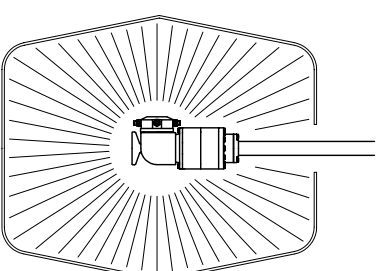
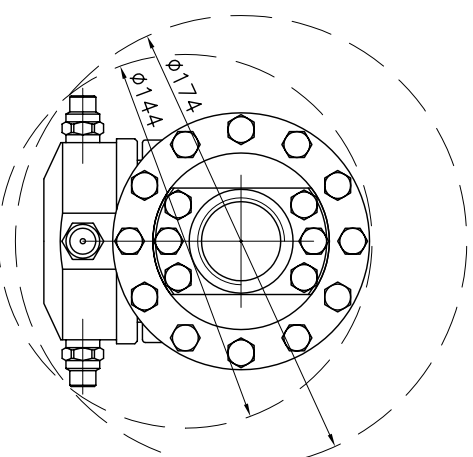
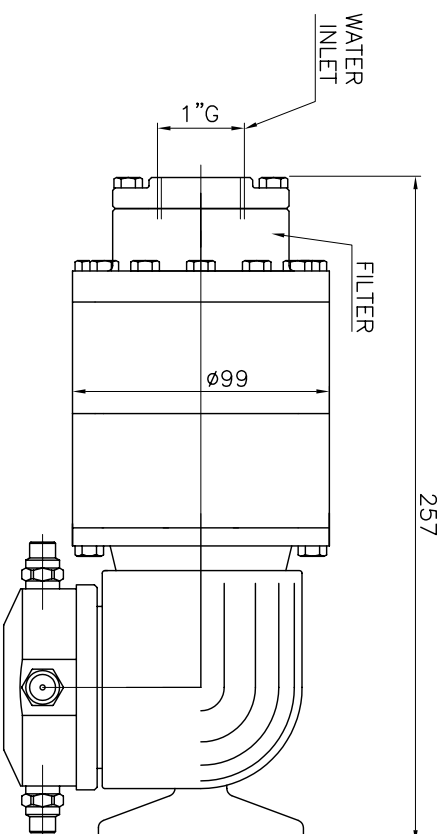

RUGOSITA' (UNI 4600)	MODIFICA	1	2	3	4	5	
FOGLIO	XXXX						
GREZZO	DATA	XX.XX.XX					
~ = ∅	TOLLERANZE GENERALI classe m	UNI-EN 22768/1					
SGROSS.	0-6	6-30	30-120	120-400	400-1000	1000-2000	
∇ = 3.2/	±0.1	±0.2	±0.3	±0.5	±0.8	±1.2	
FINITURA 1.6/	NOTE:						
∇∇ = 1.6/	DESCRIZIONE:	RW 200 A APPLICATION DRAWING					
RETTIFICA 0.8/							
∇∇∇ = 0.8/							
CODICE:		1:3		A3		O	
RW 200 A							

Bonomati
CLEANING HEADS

MONTECCHIO E. (RE) - ITALY
DISIGN.: CR ICONTR.: DM
DATA: 06.10.08 MOD.

SCALA