

TECHNICAL DATA

O.RING	EPDM
SLIPPER	PTFE+CARBON FIBER
BUSHING	NICKEL BRONZE 25%
FILTER	700 MICRON
NOZZLES POSITIONS	4
NOZZLES SIZE	1/8" NPT
OPERATING FLOW	60 L/min
OPERATING PRESSURE	150 bar
MAX TEMPERATURE	90 °C
MATERIAL	INOX AISI 316
GEARS	FIXED Z=29 ROTATING Z=31
MODULE	1
FULL CYCLE	31 ROTATIONS
FULL CYCLE TIME	1.00 MIN. AT 3 BAR AIR PRESSURE
AIR MOTOR	ATLAS COPCO BA 720 INOX
AIR EXHAUST	FESTO SILENCER BP 415 ON MOTOR
WEIGHT	6.5 KG

AIR PRESSURE AND CONSUMPTION

ROTATION SPEED	29 RPM	1 bar	264 L/min.	AIR
ROTATION SPEED	42 RPM	2 bar	288 L/min.	AIR
ROTATION SPEED	51 RPM	3 bar	300 L/min.	AIR
ROTATION SPEED	58 RPM	4 bar	306 L/min.	AIR
ROTATION SPEED	62 RPM	5 bar	312 L/min.	AIR
ROTATION SPEED	66 RPM	6 bar	324 L/min.	AIR

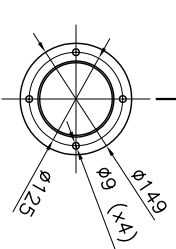

RUGOSITA' (UNI 4600)	MODIFICA	1	2	3	4	5
GREZZO	FOGLIO	XXXX				
~ = √	DATA	XXXXXXXX				
SGROSS. = √	TOLLERANZE GENERALI close m. UNI-EN 22768/1	±0.1	±0.2	±0.3	±0.5	±0.8
∇ = 3/2	NOTE:					
FINITURA 1/6	DESCRIZIONE: APPLICATION DRAWING					
∇∇ = √	XC 061 PDBD S4A					
∇∇∇ = 0.8/	file: XC 061 PDBD S4A cm					
	CODICE: XC 061PDBD S4A					

